

DISTRICT JIND

LAYOUT PLAN OF UNAUTHORISED COLONY
NEAR ROHTAK BYPASS RD TO JIND COURT ROAD
IN THE REVENUE ESTATE OF JIND
TEH. JIND AND DIST. JIND

KHASRA NO

254//17min,16min,
255//20min,21min,22min
260//5min,6min,8min,13min,14min,15min,16min,
17min,
259//1min,2min,10min,11min.

KEY PLAN

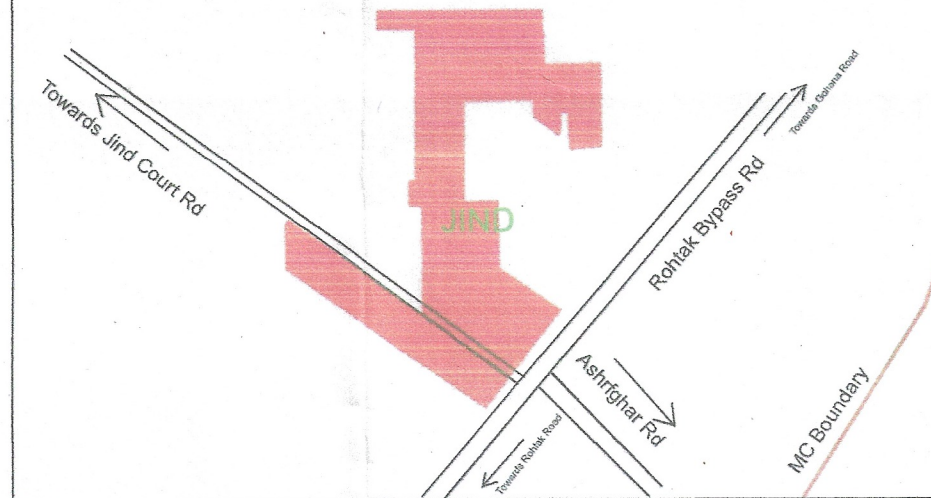

DETAILS OF UNAUTHORIZED COLONY

Sr. No.	Parameter Name	Description				
1	Colony name	Jind UC-15B				
2	Area	6.48 a/c	Acres	40512.13 Sq/M		
3	Location of the colony	Near Rohtak Bypass Road				
4	Municipal Limits Boundary (MC STATUS):	(i) Within MC	Yes			
		(ii) Outside MC	No			
		(iii) Partial MC	No			
5	Type of Colony and use (in %)	Area (%)	Area (Acres)	Area (Sq/M)		
		Residential	28%	2.78	11241.13	
		Vacant + Open	45%	4.46	18073.17	
		Road	22%	2.25	9099.03	
		Commercial	5%	0.52	2098.80	
		Industrial	6%	0.00	0.00	
		Builtup	33%	3.30	13339.93	
6	Name of Revenue Estate	Jind				
7	District Name	Jind				
8	Name of Controlled Area	Jind				
9	Urban Area	Jind				
10	Year of establishment	2021				
11	Total No. of Plots	142				
12	No. of Constructed Plots (Residential+Commercial+Industrial)	72+4+0=76				
13	Number of vacant plots	64				
14	Number of families residing in the colony	72				
15	Does the colony have street light?	No				
16	Does the colony have Electric Line	Yes				
17	Does the colony have HT Line	No				
18	Does the colony have water supply through pipelines?	No				
19	Does the colony have underground sewerage facility?	Yes				
20	Does the colony have Park or Open Space	No				
21	Road type on Colony (Kuccha/Pucca)	Kuccha & Pucca				
22	Different roads (in meters)	Road Width	Length (in mtrs)			
		Pucca Road 3.5 M TO 9 M	636.88 M			
		Kuccha Road 3.5 M TO 11 M	1367.71 M			
23	Minimum Road Width	3.5 M				
24	Area of the community site (in acres)	No				
25	Is the RWA registered	No				
26	Additional Information, if any	No				
27	Name of Electric Substation	DBVN				

$$10.01 - 1.7 = 8.31$$

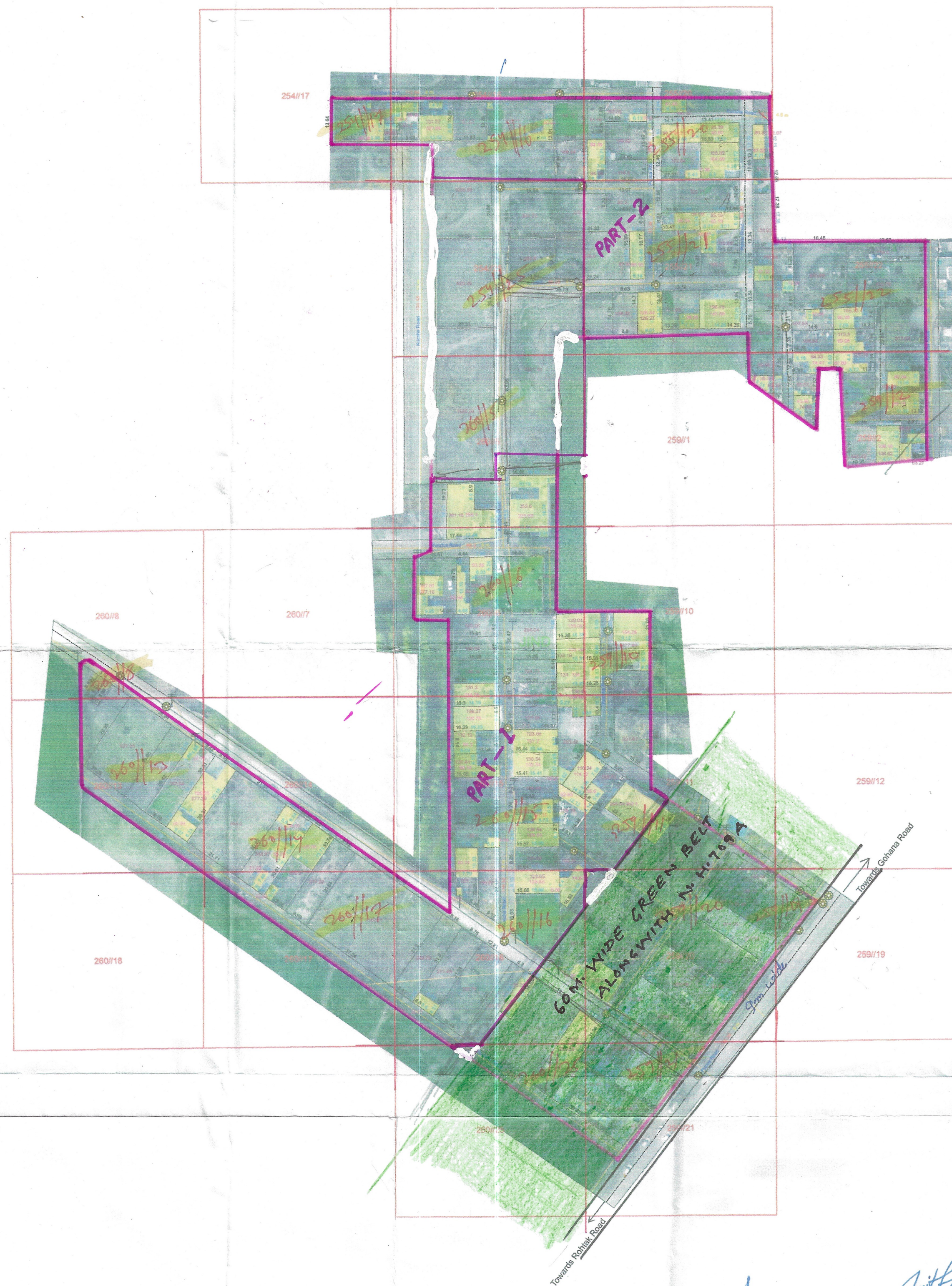

LEGEND

- Airport
- Electric Pole
- Hospital
- Man Hole
- Mobile Tower
- Mosque
- School/College (Exclude)
- Solar Pole
- Street Light
- Temple
- Transformer
- HT Line
- LT Line
- Kuccha Road
- Pucca Road
- Major Road Line
- Drainage
- Sewerage Storm water
- Kuccha Road Polygon
- Pucca Road Polygon
- Residential
- Commercial (Exclude)
- Industrial
- Plot Boundary
- Vacant Land
- Park
- Colony Boundary
- Khasra Boundary
- Revenue Estate Boundary
- Mustil Boundary
- District Boundary

NOTE:-

- * ALL DIMENSIONS ARE IN METERS AND AREA IN SQUARE METERS.
- * AREA OF RESIDENTIAL BUILDINGS IS INDICATED THROUGH PINK COLOUR.
- * AREA OF PLOT BOUNDARY IS INDICATED THROUGH PURPLE COLOUR.

DRG. NO D.T.P. (J)

DT.

LAYOUT PLAN CHECKED AND VERIFIED AT SITE BY:

PATWARI :

JUNIOR ENGINEER: Fi

JUNIOR DRAFTSMAN :

DISTRICT TOWN PLANNER :

SENIOR TOWN PLANNER :

OFFICE OF DISTRICT TOWN PLANNER, JIND
TOWN & COUNTRY PLANNING DEPTT, HARYANA

District Municipal Council, Jind

Executive Officer
Municipal Council, JindExecutive Engineer
Municipal Council, JindMunicipal Engineer
Municipal Council, Jind

Jind UC-15B

(JE)
H.C. Jind

SCALE : 1 CM = 10 M

0 5 10 20 30
M

DRONE SURVEY AND LAYOUT PLAN PREPARED BY:-



CHECKED :	SURVEYOR :	SCALE :-
DRAWN BY :-		
DRAWING NO. :- Jind-UC-15B	SHT. NO.	REV. NO.