

LOCATION PLAN

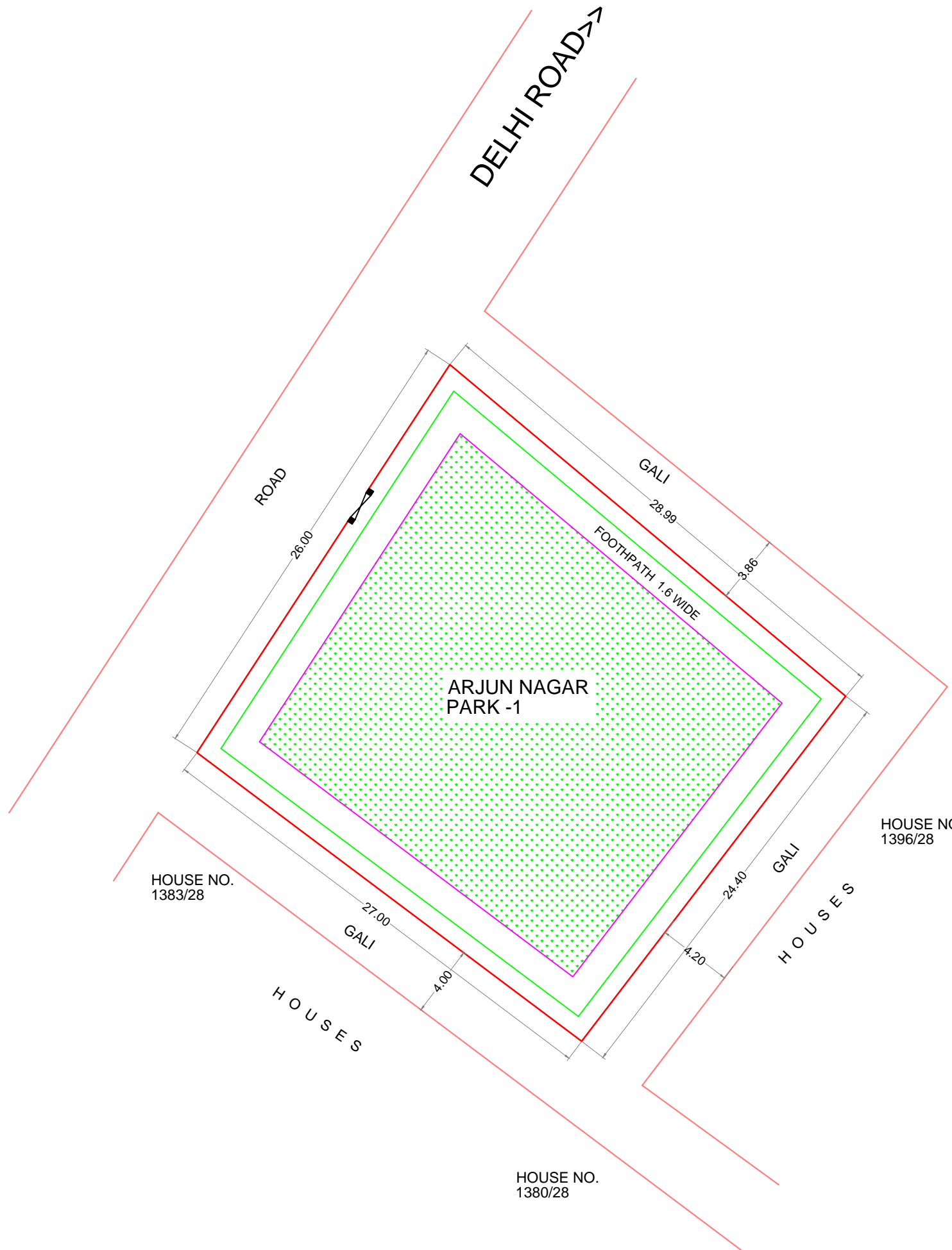
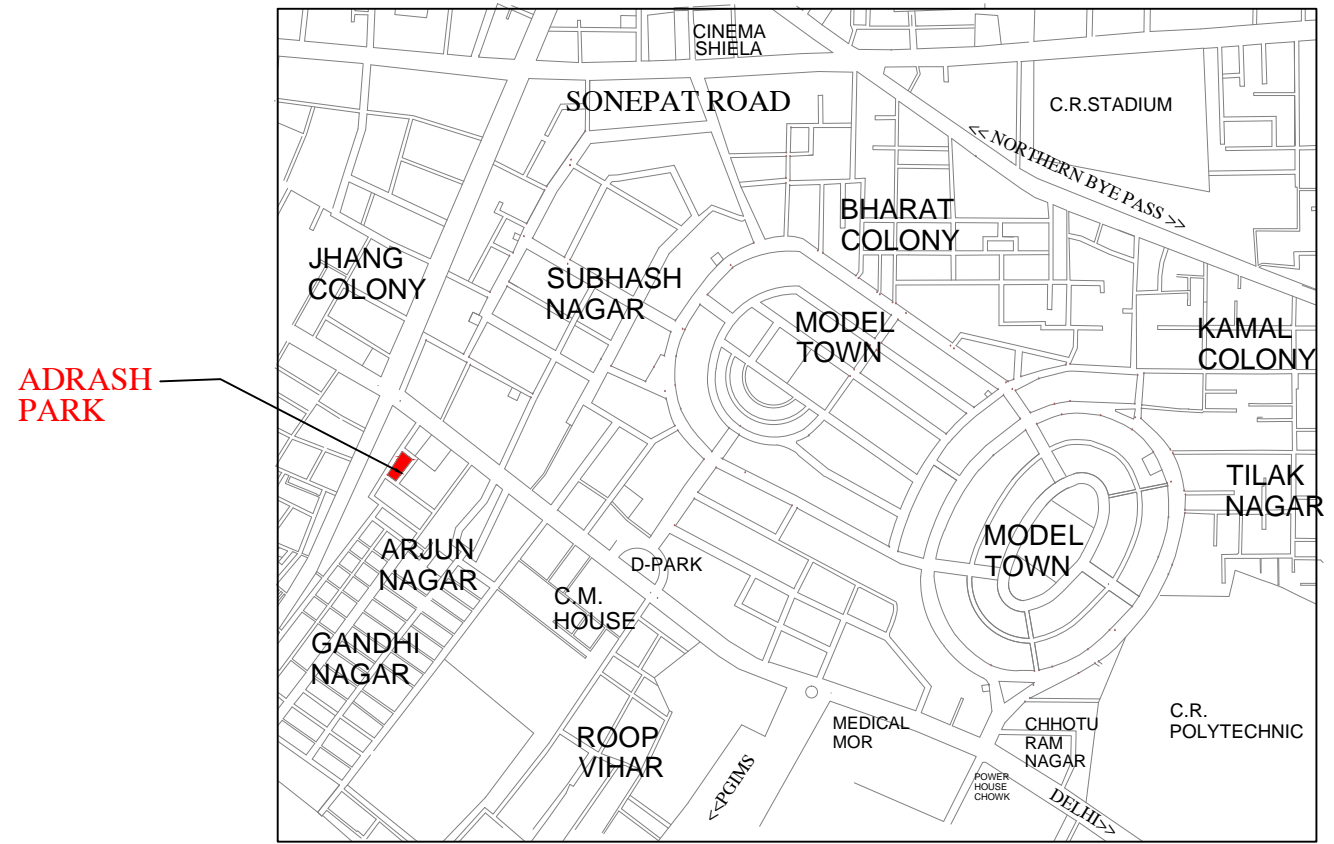

NOTES :
 ALL DIMENSIONS ARE IN METERS
 AREA OF PARK = 703.60 Sqm

- REFERENCES :
- JHULA J
 - BANCH C
 - GATE
 - FOOT PATH
 - FLOWER BED
 - BOUNDARY WALL
 - LAMP POST OLP
 - OTHERS WALL

OWNERS MUNICIPAL CORPORATION ROHTAK	
TITLE LAY OUT PLAN OF ARJUN NAGAR PARK-1 ARJUN NAGAR, ROHTAK	
CONSULTANTS SURCON SURVEYORS SURVEY & CIVIL ENGINEERING 1597 / 21, CHUNNI PURA, ROHTAK- 124001 PH : 9215546717, 09818085262, 9416046717 PH : (RES.) : 01262 - 246717 Email : surconsurveyors@gmail.com	DRG.NO. SS/ DATE NOV 2013 SCALE 1:250 SURD.BY